

# 2010 Carriage Cameo Fifth Wheel

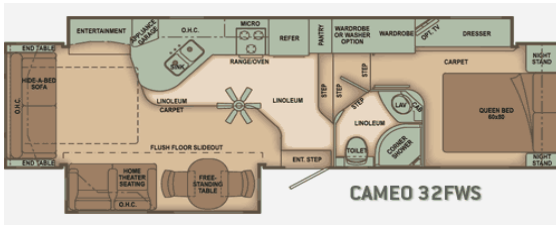

32' 11" = 10,03M

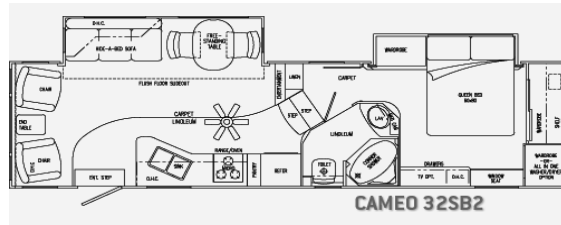

32' 11" = 10,03M

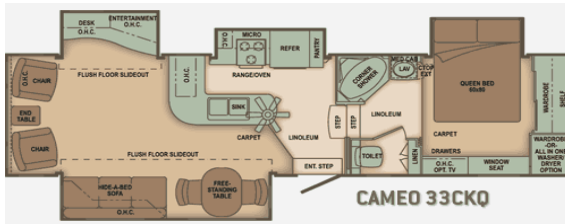

33' 11" = 10,34M

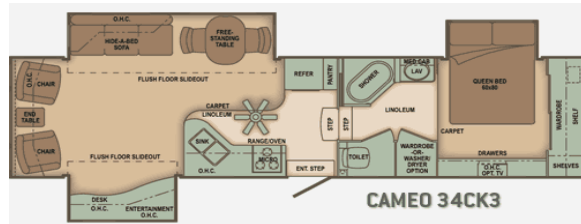

34' 11" = 10,64M

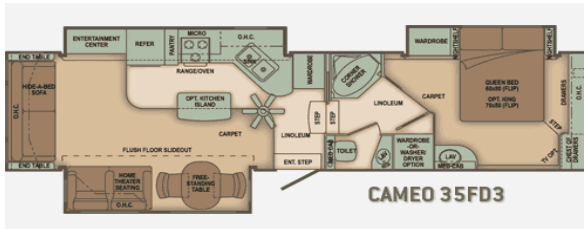

35' 11" = 10,95M

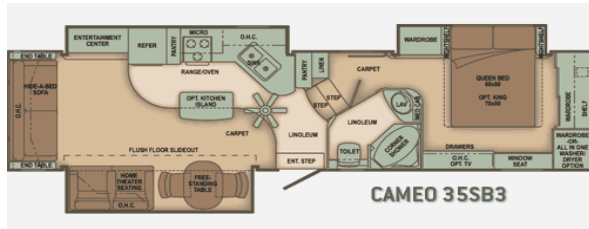

35' 11" = 10,95M

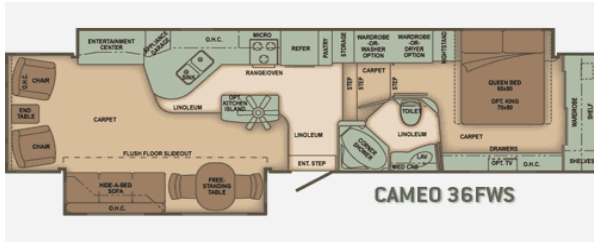

36' 11" = 11,25M

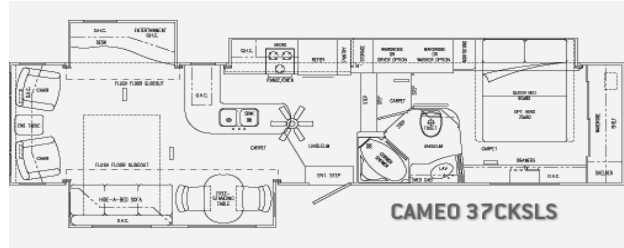

TBA

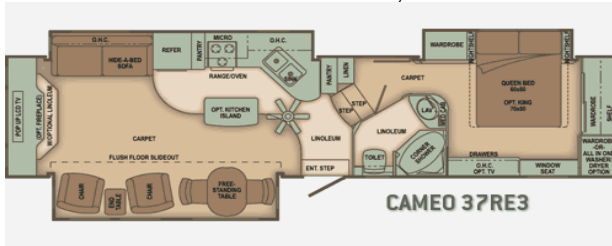

37' 5" = 11,41M

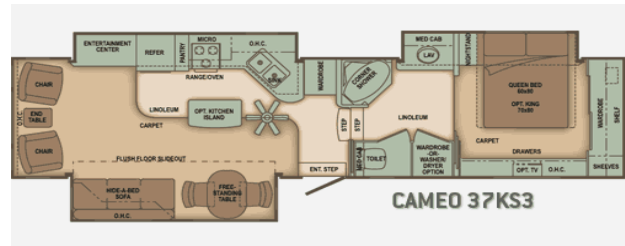

37' 5" = 11,41M

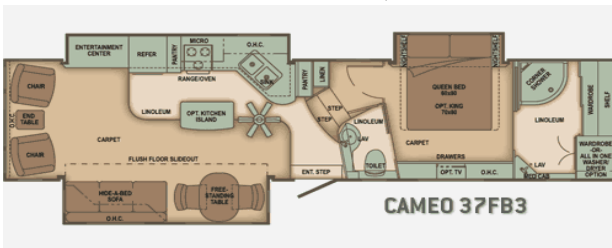

37' 5" = 11,41M

[www.carriageinc.com](http://www.carriageinc.com)

**Mandatory Packages:**

**Carriage "Bigfoot" Package**

- 4 individual cylinder/jacks
- Fully automatic controls
- 17,000 per jack capacity
- Five year warranty

**Carriage "Luxury" Package**

- 32" Samsung LCD TV (26" Samsung TV in F32SB2, 37" Samsung TV in F37RE3)
- Samsung FM/CD/DVD home theatre system 5.1 w/ subwoofer,
- Ext. E-center prep in basement
- Window in stool room
- 15K BTU high capacity A/C
- Two leather recliners or theater seating (floorplan applicable)
- Three zone halogen lighting w/dimmer switches
- Carefree Travel-R electric awning
- Hi-gloss gel coat fiberglass
- 2 luxury folding chairs
- 2 dinette chairs & table w/leaf
- 60 x 80 pillowtop queen mattress
- 2nd satellite prep to bedroom
- Interior window wood trim
- Baggage door struts
- Frameless Hehr® windows
- Ball bearing drawer guides
- Hardwood stiled cabinetry

## **Carriage "Performance" Package**

Corian countertops in kitchen & bath  
E-Z Lube axles  
MOR/ryde® rubber equalizer suspension system  
Aluminum wheels  
Day/night shades livingroom/kitchen  
Black-out Shades in Bedroom  
50 amp service  
Universal docking station  
Spare tire w/crank up mount  
Hide-a-bed sofa w/air mattress  
Stainless steel deep bowl sink  
30" Sharp OTR microwave  
2nd AC prep  
Tongue & groove plywood flooring  
Vinyl TPO roof  
Washer/dryer prep  
Battery disconnect