

2010 Carriage Royals International Fifth Wheel

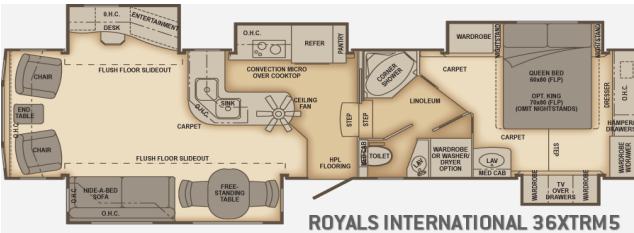

36' 11" (11.1 m)

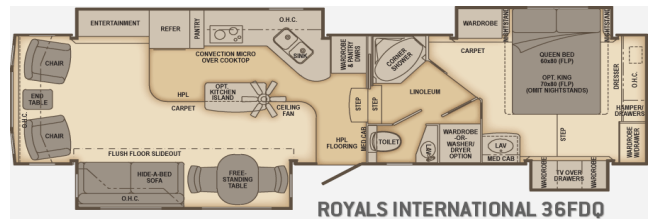

36' 11" (11.1 m)

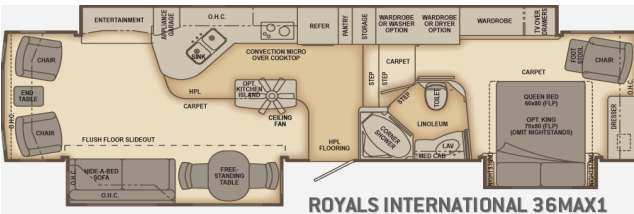

36' 11" (11.1 m)

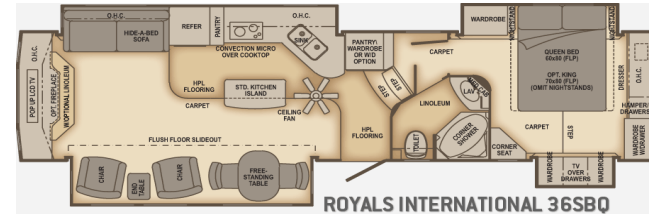

36' 11" (11.1 m)

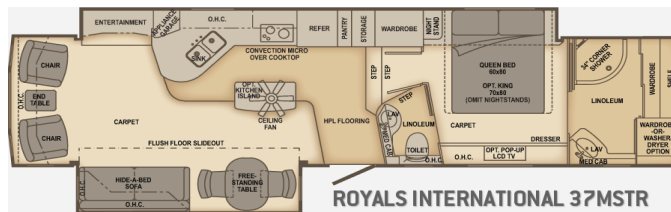

37' 11" (11.5 m)

STANDARD FEATURES

Generator prep
Central vacuum system
Astro Foil in sidewalls
Universal docking station
Satellite prep for bedroom & living room
Black out shades in bedroom

ROYALS INTERNATIONAL "LUXURY" PACKAGE*

37" Sony LCD TV (46" in 36SBQ)
Sony AM/FM/CD/DVD home theatre system 5.1 with subwoofer
22" Sansui LCD TV in bedroom
DVD player in bedroom
Bose bedroom CD stereo /alarm clock
Floor safe
Pillow top Mattress
Three zone halogen lighting with dimmer switches
Whole house water filter
2 leather recliners
2 fully upholstered dinette chairs & 2 folding padded dinette chairs
Convection Microwave vented to the outside
Ball bearing roller drawer guides
12 cu ft refrigerator w/ side by side doors & icemaker
(icemaker N/A on 36XTRM5)
Power push button antenna
Fantastic vent w/ wall switch in kitchen

ROYALS INTERNATIONAL "BEST BUILT" PACKAGE*

Bigfoot hydraulic leveling system
Nev-R-Lube bearings
Greaseable shackles
40# LP bottles with auto changeover
110v reception basement
TV outlet in basement
Rear second basement
Frameless Hehr windows
12 Gal gas/electric water heater with DSI
Low profile ducted A/C with heat pump 16K
50-amp electrical service
Upgraded Royals slide fascia

ROYALS INTERNATIONAL "PERFORMANCE" PACKAGE*

Zodiac quartz counter tops in kitchen & bath
Hardwood cabinet stile
MOR/ryde® pin box
Sliding battery tray & LP sliding tray
4-step entry
Hide-a-bed sofa with air mattress
Hi-gloss gel-coat sidewalls
MOR/ryde® impendent suspension with 8000# axles
and disc brakes
2 Carefree Travel-R-Electric awnings with Uni-guard
2nd AC Carrier 13.5k ducted bedroom

*Packages are mandatory

www.carriageinc.com